



Secretariat of Addu City Council,
Addu City, Maldives

No: (IUL)426-AB/426/2020/370

Date: 26th November 2020

Amendment to IFB and ITB - 03

Regarding Invitation for Bids (IFB) for the Lease, Development and Operation of Tourist Guesthouse and City Hotel in Addu City,

Reference No: (IUL) 426-AB/426/2020/309 (12th October 2020)

The Addu City Council (the “**Council**”), representing the Government of Maldives, hereby announces the *third* Amendment to Invitation for Bids (the “IFB”) and Information to Bidders (the “ITB”) for the Lease, Development and Operation of Tourist Guesthouses and City Hotels in Addu City Reference No: (IUL) 426-AB/426/2020/309, (12th October 2020)

Amendment to Annex I, Annex II, Annex III, Annex IV and Annex V

Annex I

Annex I of the ITB for the Lease, Development and Operation of Tourist Guesthouses and Hotels in Addu City is hereby amended and replaced in its entirety with Annex I attached with this Amendment.

Annex II

Annex II of the ITB for the Lease, Development and Operation of Tourist Guesthouses and Hotels in Addu City is hereby amended and replaced in its entirety with Annex II attached with this Amendment.

Annex III

Annex III of the ITB for the Lease, Development and Operation of Tourist Guesthouses and Hotels in Addu City is hereby amended and replaced in its entirety with Annex III attached with this Amendment.



Annex IV

Annex IV of the ITB for the Lease, Development and Operation of Tourist Guesthouses and Hotels in Addu City is hereby amended and replaced in its entirety with Annex IV attached with this Amendment.

Annex V

Annex V of the ITB for the Lease, Development and Operation of Tourist Guesthouses and Hotels in Addu City is hereby amended and replaced in its entirety with Annex V attached with this Amendment.



ANNEX I

Map of the Land allotted in Hithadhoo as Hithadhoo Tourism Zone (S2)

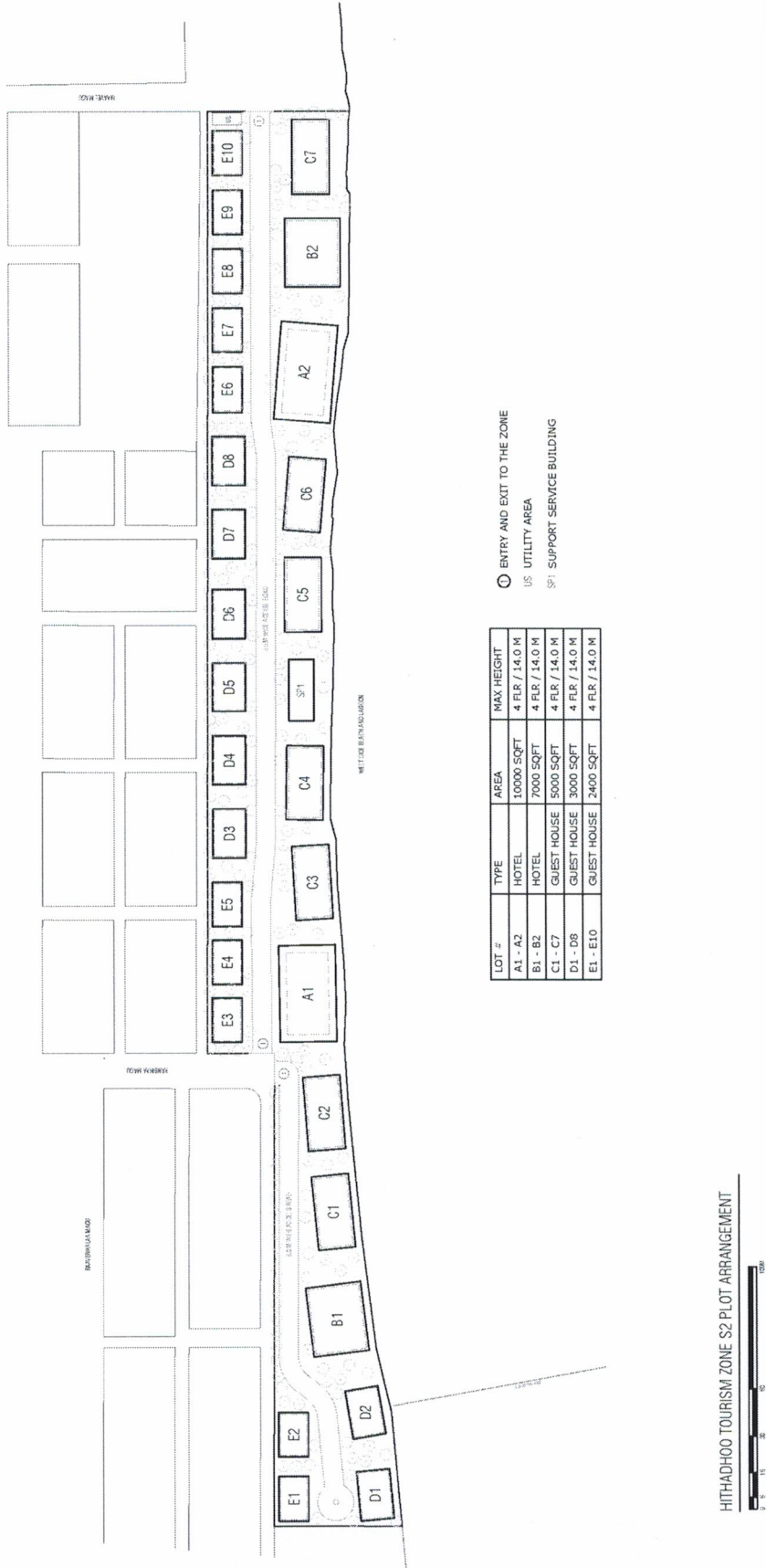

HITHADHOO TOURISM ZONE S2 PLOT ARRANGEMENT



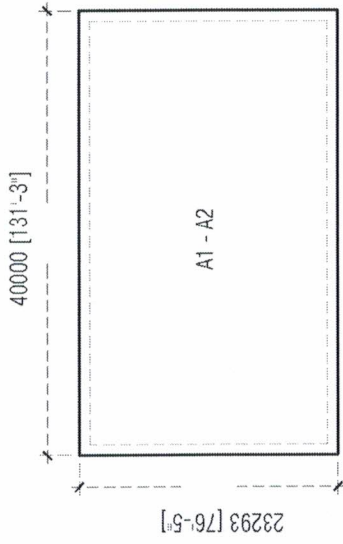

A1 - A2: 2 Nos
CITY HOTEL
10,000 SQFT
4 FLR / 14.0 M
1.0 M SETBACK FROM ALL SIDES

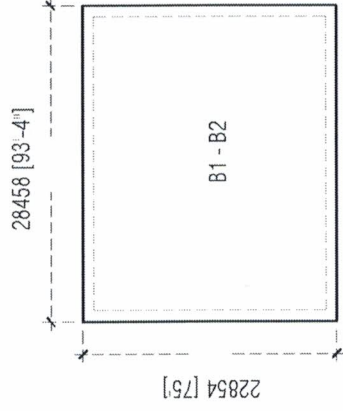

B1 - B2: 2 Nos
CITY HOTEL
7,000 SQFT
4 FLR / 14.0 M
1.0 M SETBACK FROM ALL SIDES

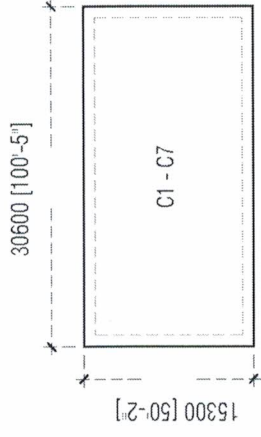

C1 - C7: 7 Nos
GUEST HOUSE
5,000 SQFT
4 FLR / 14.0 M
1.0 M SETBACK FROM ALL SIDES

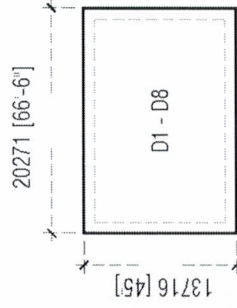

D1 - D8: 8 Nos
GUEST HOUSE
3,000 SQFT
4 FLR / 14.0 M
1.0 M SETBACK FROM ALL SIDES

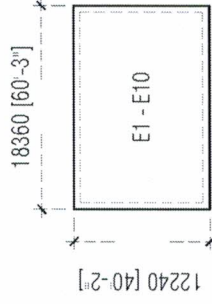

E1 - E10: 10 Nos
GUEST HOUSE
2,400 SQFT
4 FLR / 14.0 M
0.6 M SETBACK FROM ALL SIDES

HITHADH00 S2 PLOT DETAILS



ANNEX II

Map of the Land allotted in Feydhoo as Dhigihere Tourism Zone (S4)

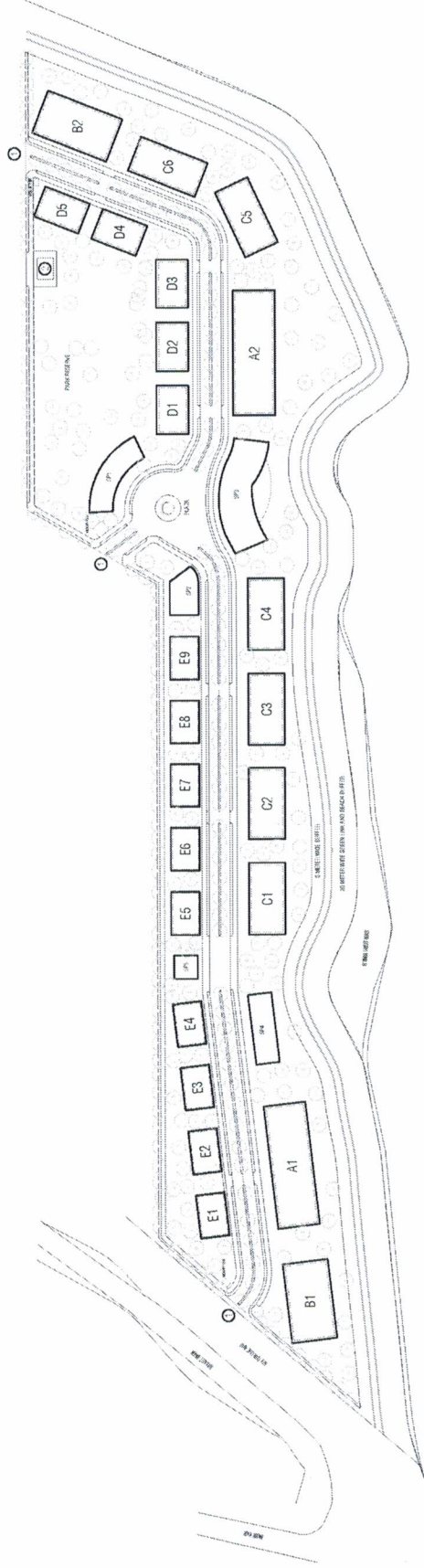

LOT #	TYPE	AREA	MAX HEIGHT
A1 - A2	HOTEL	10000 SQFT	4 FLR / 14.0 M
B1 - B2	HOTEL	7000 SQFT	4 FLR / 14.0 M
C1 - C6	GUEST HOUSE	5000 SQFT	4 FLR / 14.0 M
D1 - D5	GUEST HOUSE	3000 SQFT	4 FLR / 14.0 M
E1 - E9	GUEST HOUSE	2400 SQFT	4 FLR / 14.0 M

- SP1 - SP: SUPPORT BUILDING
- ACCESS ENTRY & EXIT
- ⊗ WASTE COLLECTION POINT

FEYDHOO TOURISM ZONE S4 PLOT ARRANGEMENT



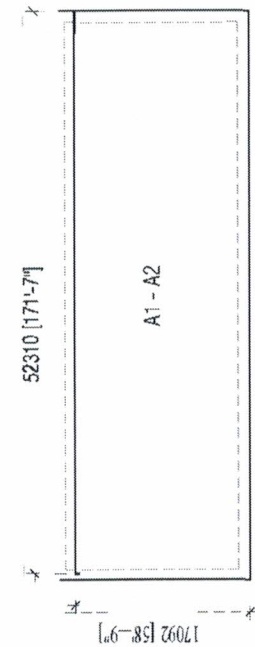

A1 - A2, 2 Nos
CITY HOTEL
10,000 SQFT
4 FLR / 14.0 M
1.0 M SETBACK FROM ALL SIDES

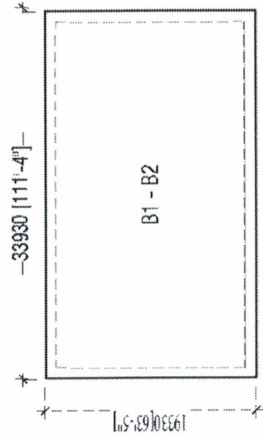

B1 - B2, 2 Nos
CITY HOTEL
7,000 SQFT
4 FLR / 14.0 M
1.0 M SETBACK FROM ALL SIDES

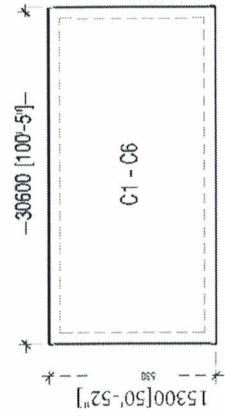

C1 - C6, 6 Nos
GUEST HOUSE
5,000 SQFT
4 FLR / 14.0 M
1.0 M SETBACK FROM ALL SIDES

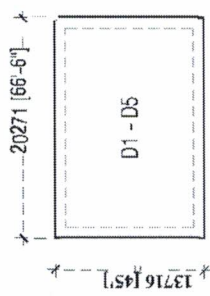

D1 - D5, 5 Nos
GUEST HOUSE
3,000 SQFT
4 FLR / 14.0 M
1.0 M SETBACK FROM ALL SIDES

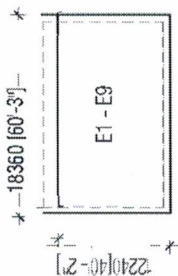

E1 - E9, 9 Nos
GUEST HOUSE
2,400 SQFT
4 FLR / 14.0 M
0.5 M SETBACK FROM ALL SIDES

FEYDH00 S4 PLOT DETAILS



ANNEX III

Map of the Land allotted in Maradhoo as Venbolhafishi Tourism Zone (S3)

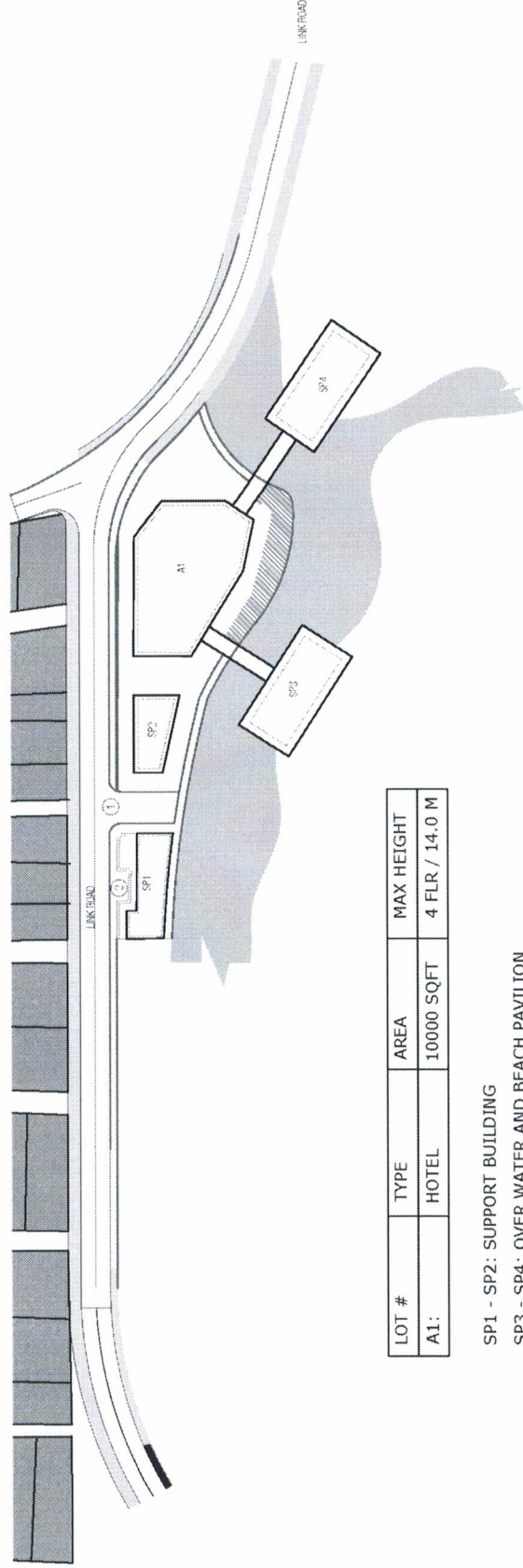

LOT #	TYPE	AREA	MAX HEIGHT
A1:	HOTEL	10000 SQFT	4 FLR / 14.0 M

- SP1 - SP2: SUPPORT BUILDING
- SP3 - SP4: OVER WATER AND BEACH PAVILION
- ① MAIN ACCESS ENTRY & EXIT
- ② WASTE COLLECTION POINT

MARADHOO TOURISM ZONE S3 PLOT ARRANGEMENT



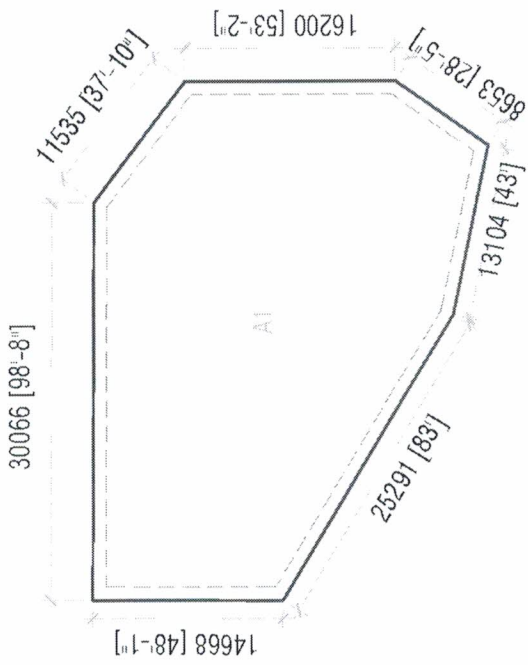

A1: 1 Nos
 CITY HOTEL
 10,000 SQFT
 4 FLR./14.0M
 1.0M SETBACK FROM ALL SIDES

MARADH00 S3 PLOT DETAILS



ANNEX IV

Map of the Land allotted in Hulhudhoo as Maafishi Tourism Zone (S6)

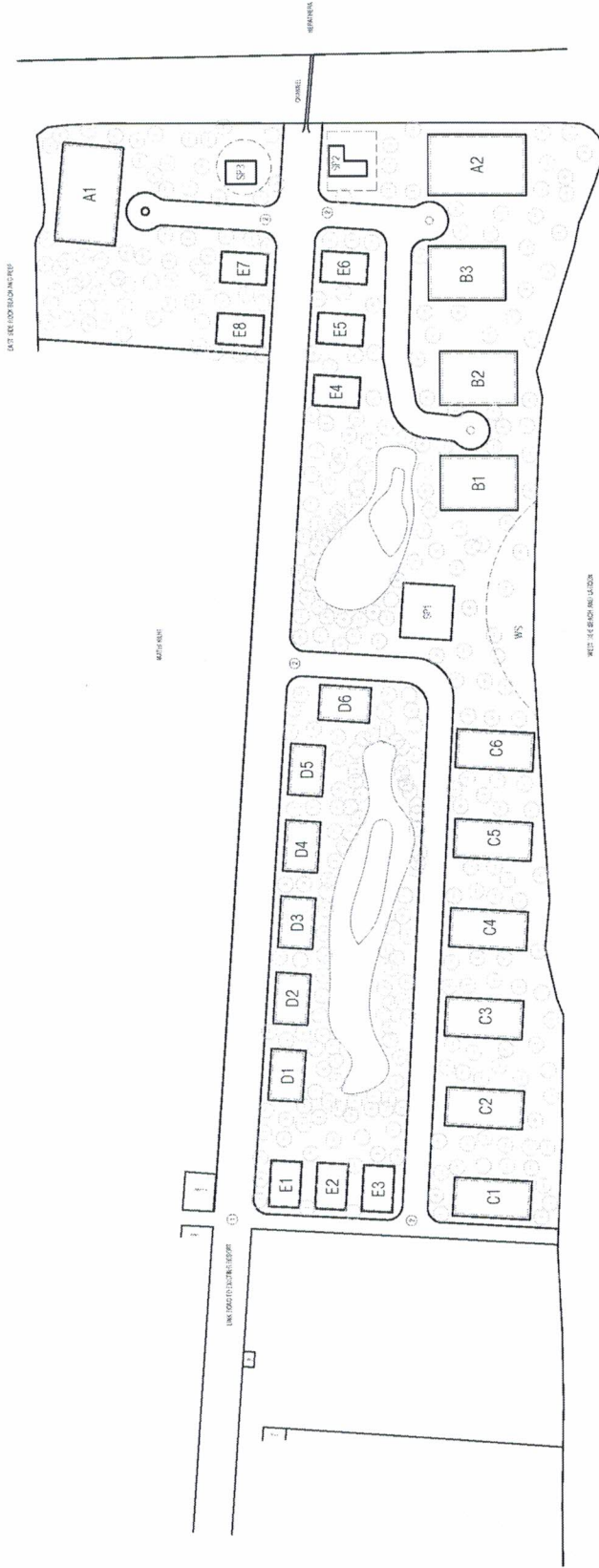

LOT #	TYPE	AREA	MAX HEIGHT
A1 - A2:	HOTEL	10000 SQFT	4 FLR / 14.0 M
B1 - B3:	HOTEL	7000 SQFT	4 FLR / 14.0 M
C1 - C6:	GUEST HOUSE	5000 SQFT	4 FLR / 14.0 M
D1 - D6:	GUEST HOUSE	3000 SQFT	4 FLR / 14.0 M
E1 - E8:	GUEST HOUSE	2400 SQFT	4 FLR / 14.0 M

- SP1 - SP3: SUPPORT BUILDING
- WS: COMMUNAL BEACH AND WATER SPORTS AREA
- ① MAIN ACCESS ENTRY & EXIT TO RESORT AND TOURISM AREA
- ② ENTRY & EXIT TO HOTEL ZONES FROM LINK ROAD

HULHUDHOO TOURISM ZONE S6 PLOT ARRANGEMENT



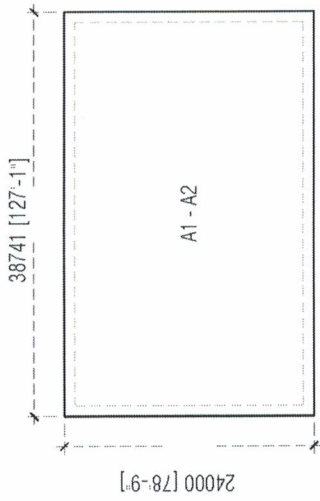

A1 - A2: 2 Nos
CITY HOTEL
10,000 SQFT
4 FLR / 14.0 M
1.0 M SETBACK FROM ALL SIDES

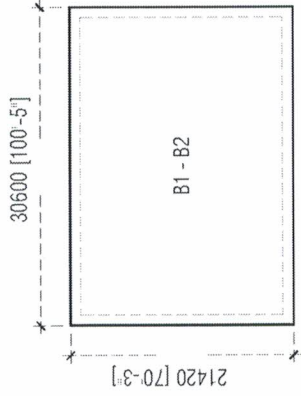

B1 - B2: 2 Nos
CITY HOTEL
7,000 SQFT
4 FLR / 14.0 M
1.0 M SETBACK FROM ALL SIDES

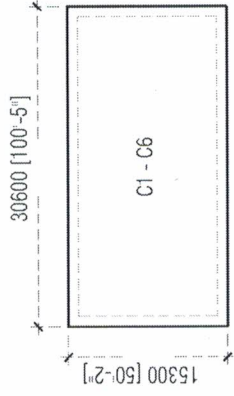

C1 - C6: 6 Nos
GUEST HOUSE
5,600 SQFT
4 FLR / 14.0 M
1.0 M SETBACK FROM ALL SIDES

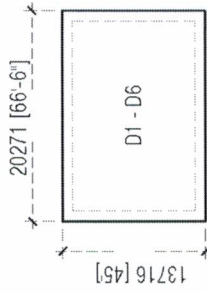

D1 - D6: 6 Nos
GUEST HOUSE
3,000 SQFT
4 FLR / 14.0 M
1.0 M SETBACK FROM ALL SIDES

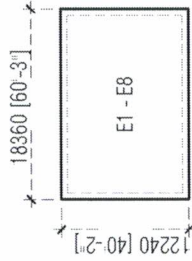

E1 - E8: 8 Nos
GUEST HOUSE
2,400 SQFT
4 FLR / 14.0 M
0.6 M SETBACK FROM ALL SIDES

HULHUDH00 S6 PLOT DETAILS



ANNEX V

Map of the Land allotted in Meedhoo as Mulimathi Tourism Zone (S1)

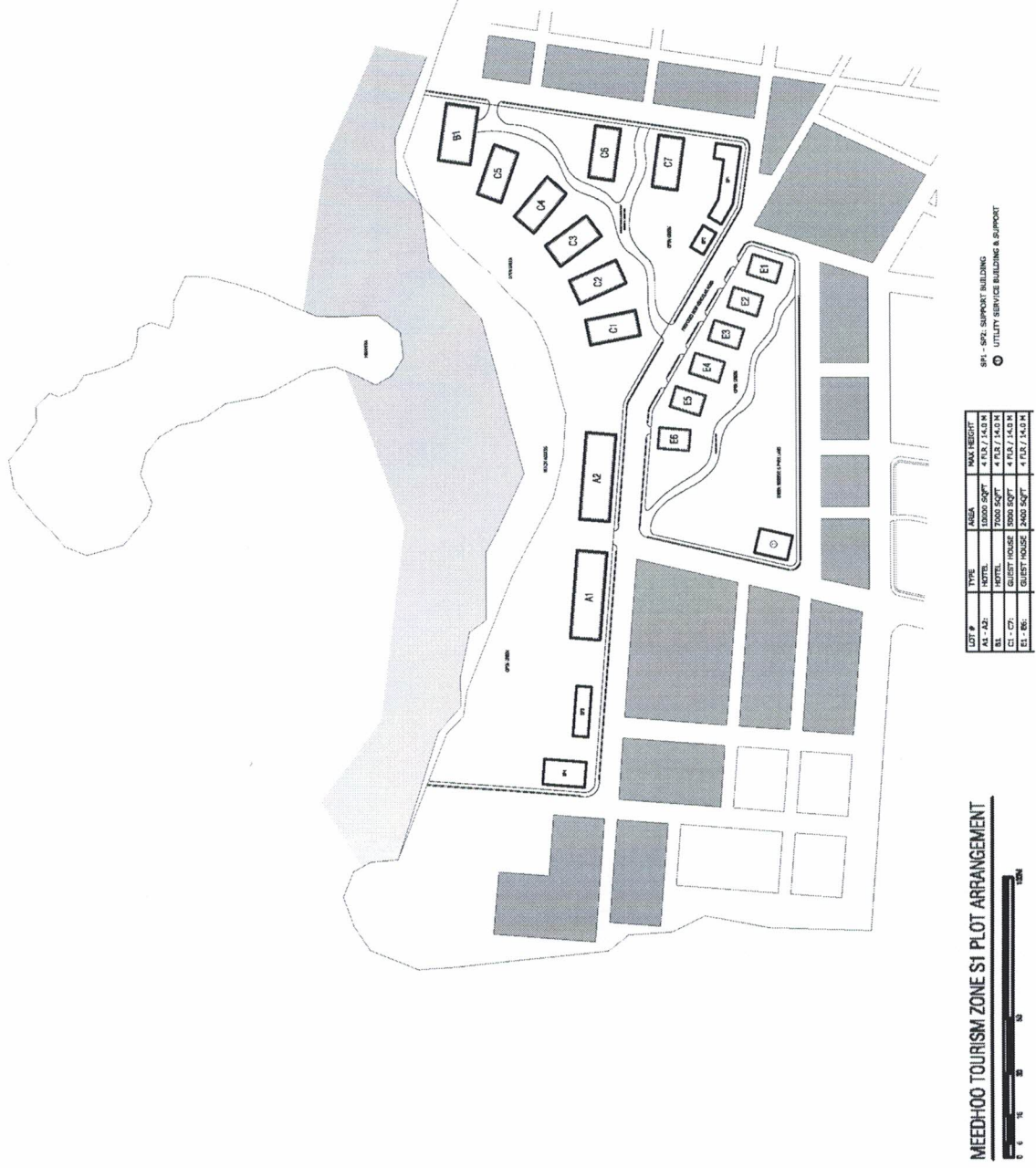

38741 [127'-1"]

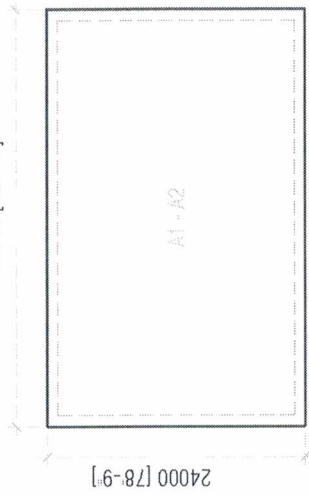

A1 - A2: 2 Nbs
 CITY-HOTEL
 10,000 SQFT
 4 FLR / 14.0M
 1.0M SETBACK FROM ALL SIDES

30600 [100'-5"]

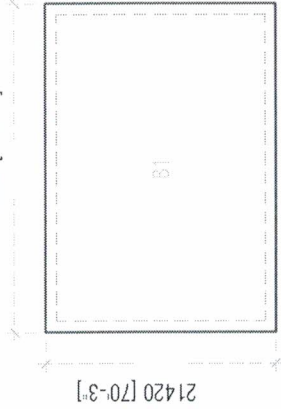

B1: 1 Nbs
 CITY-HOTEL
 7,000 SQFT
 4 FLR / 14.0M
 1.0M SETBACK FROM ALL SIDES

24695 [81']

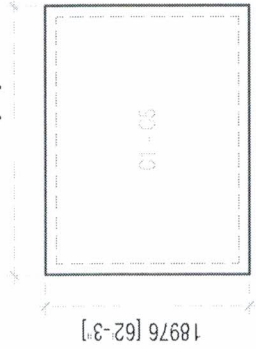

C1 - C5: 5 Nbs
 GUEST HOUSE
 5,000 SQFT
 4 FLR / 14.0M
 1.0M SETBACK FROM ALL SIDES

30600 [100'-5"]

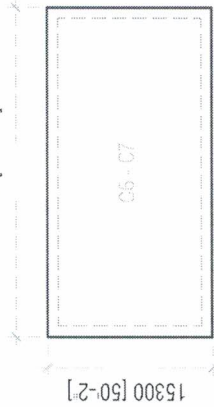

C6 - C7: 2 Nbs
 GUEST HOUSE
 5,000 SQFT
 4 FLR / 14.0M
 1.0M SETBACK FROM ALL SIDES

18360 [60'-3"]

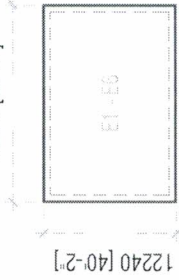

E1 - E6: 6 Nbs
 GUEST HOUSE
 2,400 SQFT
 4 FLR / 14.0M
 0.6M SETBACK FROM ALL SIDES

MEEDH00 S1 PLOT DETAILS

